

# Office to let

## Gara Herastrau

Bucharest, Sector 2, 4B Gara Herastrau St.



### Building information

Building status	Existing
Year of construction	2016
Parking ratio	1 / 76 sq m
Total building area	12 000 sq m

### Commercial terms

Office space*	after login *
Parking	after login *
Service charge*	after login *
Minimum lease term	after login *
Availability	after login *

\* Asking terms for m<sup>2</sup>/month

### Location



### Available space

Building completely leased

## Typical floor plan

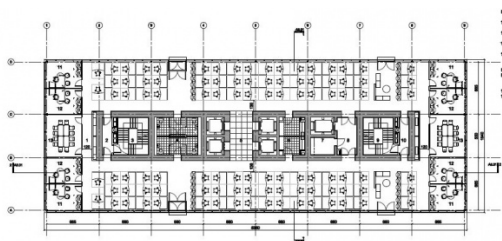

## Public transport

Metro: Aurel Vlaicu (M2)

Bus: 112, 135, N119, N123, N125,

Tram: 5

Contact



+40 21 302 3400

More information